

Dispenser placement guide for long-term care

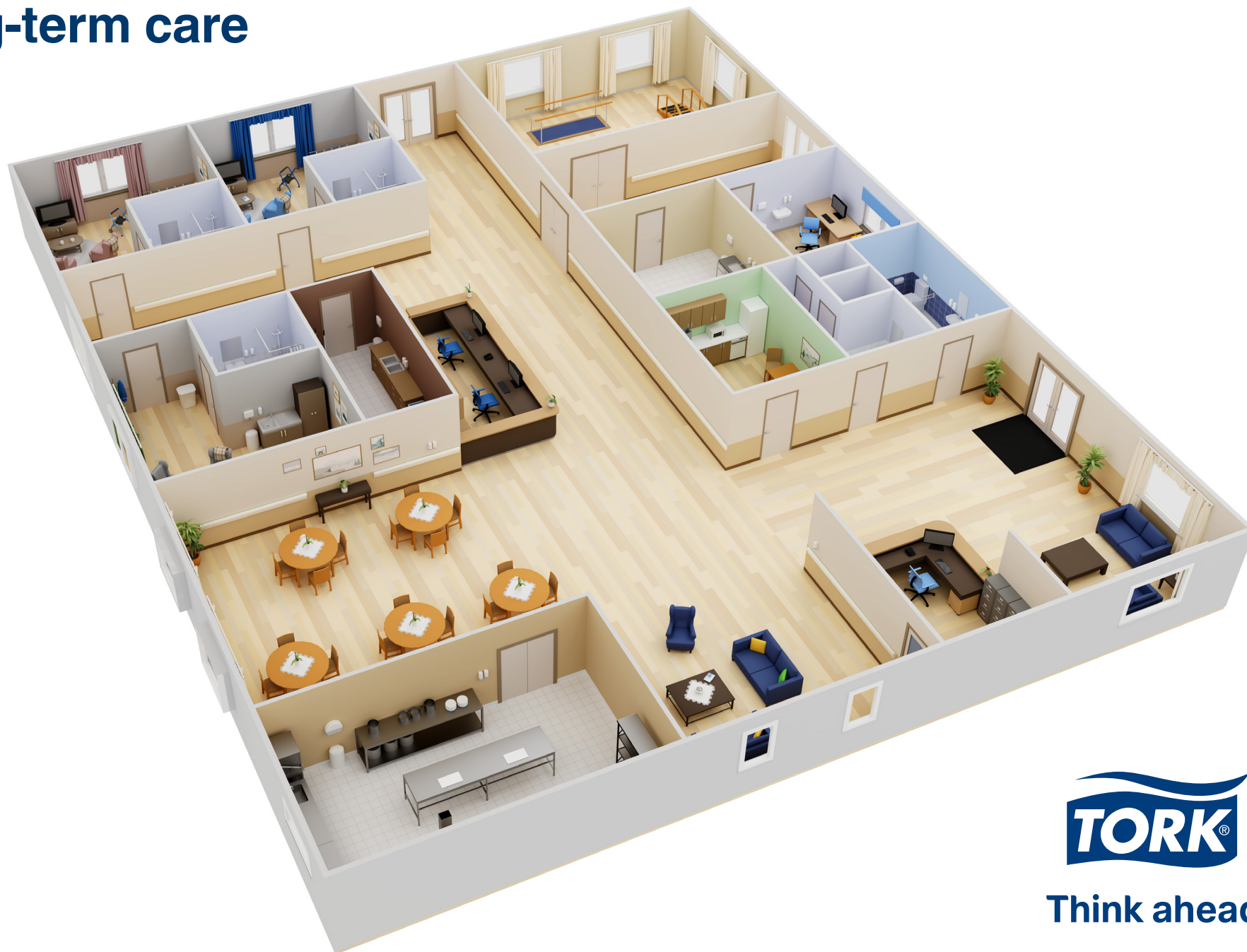

Think ahead.

Public and staff areas

Dispenser placement recommendations for care homes

In public spaces and staff areas, dispenser visibility is very important for improved hygiene. Many visitors do not clean their hands when entering the facility*. Giving easy access to and information about the importance of hand hygiene could have great benefits.



1

Entrance

Place hand sanitisers prominently at all entrances for visitors and staff. Use signs and posters to promote hand hygiene.

2

Day room/Lounge

A day room or a lounge is a room with many shared spaces and the risk of contamination is prevalent. We recommend hand sanitisers either on the walls or stands. Place a centrefeed dispenser with towels here for spills. Soap and hand towels in the kitchenette and napkin dispensers on the tables.

3

Utility room

Utility rooms play a critical role in infection control. We recommend conducting a workflow analysis to strategically place the hand-hygiene dispensers in this room.

4

Public washroom

Hand sanitisers along with hand soap and hand towels should be available next to the sink in public washrooms. Use posters with instructions on how to wash your hands. Change the posters regularly for optimal attention.

Kitchen, dining and nourishment areas

Dispenser placement recommendations for care homes

Elderly people are often a group at risk; this is why carefully preparing and selecting food is important for their safety. Good hand hygiene and cleaning is therefore essential to prevent harmful microorganisms from spreading and growing, and to avoid food poisoning. Food poisoning can cause very serious illnesses and infectious diseases can be more prone to spread in care settings.



5

Kitchen and dining

Food preparation areas should have a sufficient number of sinks dedicated to hand hygiene. Each washstation should be equipped with soap and paper-towel dispensers. Easy access to cleaning products is a simple way to keep on top of hygiene. We recommend small or portable dispensers for crowded spaces at work stations. Napkin dispensers on every table in the dining area will be appreciated.

6

Nourishment room

Ensure that soap and hand towels are close to the sink and that hand sanitiser is available in the nourishment room. Secure access to surface-cleaning products to wipe down counters and spills in the fridge.

Resident rooms and care areas

Dispenser placement recommendations for care homes

Identifying the resident zone is particularly challenging in care homes, since residents are more mobile in the care home or facility as opposed to when they are hospitalised. However, “the point of care” is exactly where the care action takes place and is defined as “the place where three elements come together”: the resident, the healthcare worker and care. Make sure dispensers are strategically placed. Here’s what we recommend.



7

Medication room

Combining the administrative work with handling medication in the medication room calls for clean hands. Make sure there is soap and hand-towel dispensers available by the sink. And make sure hand sanitiser is available in the room.

8

Examination room/Therapy

The examination room and the therapy room need easy access to hygiene dispensers. Install hand sanitisers at the point of care, preferably locked and mounted on the wall. Make sure hand-towel and soap dispensers are close to the sink. Make sure there are surface-hygiene products to wipe down counters and exam tables after resident use as well as equipment and mats in the therapy room.

9

Resident rooms

Washroom dispensers from Tork are “Easy to use”^{*} certified. Make sure you choose intuitive dispensers for toilet paper and soap in the resident room so the resident can be as independent as possible. We recommend soap, hand-towel, hand-sanitiser and toilet-paper dispensers. Careful consideration should be given to the placement of hand-hygiene dispensers in areas with residents that are disoriented.*

10

Nurse station

The possibility of cross transmission is increased in this area where you share the space. Make sure hand-sanitiser dispensers are mounted at the nurse station. We recommend having surface-cleaning products available to wipe down shared workspaces and phones.